

Note
 1. Do not scale. This drawing is to be read in conjunction with all other contract drawings and documents.

- Key**
- Proposed Shared Cycleway/Footway
 - Footway
 - Proposed widening of Footway
 - Reduced area of Footway
 - Existing Island to be removed
 - Proposed Kerblines or Edging
 - Existing Kerb line
 - Parking / Bus stop
 - Proposed Buff coloured tactile paving
 - Proposed Corduroy paving
 - "Ahead or Right Turn"
 - Proposed sign
 - Proposed Street Light
 - Proposed trees to replace existing trees

For Reference purpose only:-
 Proposed Centre line

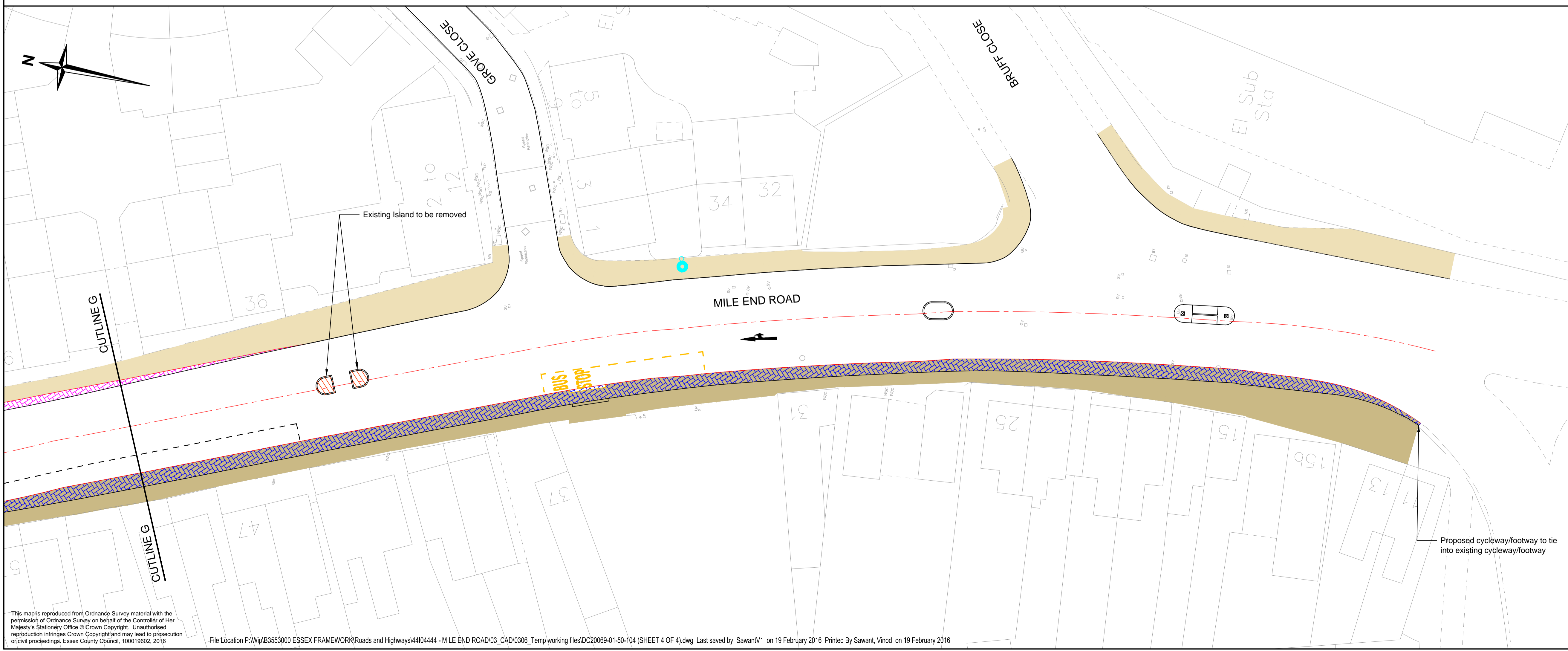

Rev.	Date	Description of revision	Drawn	Checked	Reviewed	Approved

DRAWING STATUS
FOR INFORMATION



Mark Rowe, Service Director, Highways
 Seax House, Victoria Road South, Chelmsford, CM1 1QH.
 Tel: 0345 6037631
 © Essex County Council

SCHEME TITLE
**MILE END ROAD
 FOOTWAY/CYCLEWAY**

DRAWING TITLE
**PUBLIC INFORMATION PLAN
 (SHEET 4 OF 4)**

DESIGNED	DRAWN	CHECKED	REVIEWED	APPROVED
RG	VS	JG	ML	ML
DATE	DATE	DATE	DATE	DATE
18/02/16	18/02/16	18/02/16	18/02/16	18/02/16

DRAWING UNITS U.N.O. SCALE AT A1 (841X594mm)
 DIMENSIONS IN METRES 1:250

DRAWING No. **DC20069-01-50-104** REV. -

This map is reproduced from Ordnance Survey material with the permission of Ordnance Survey on behalf of the Controller of Her Majesty's Stationery Office © Crown Copyright. Unauthorised reproduction infringes Crown Copyright and may lead to prosecution or civil proceedings. Essex County Council, 100019602, 2016
 File Location P:\wip\B3553000 ESSEX FRAMEWORK\Roads and Highways\4404444 - MILE END ROAD\03_CAD\0306_Temp working files\DC20069-01-50-104 (SHEET 4 OF 4).dwg Last saved by SawantV1 on 19 February 2016. Printed By Sawant, Vinod on 19 February 2016